

Bridge to Black Horse Chapel

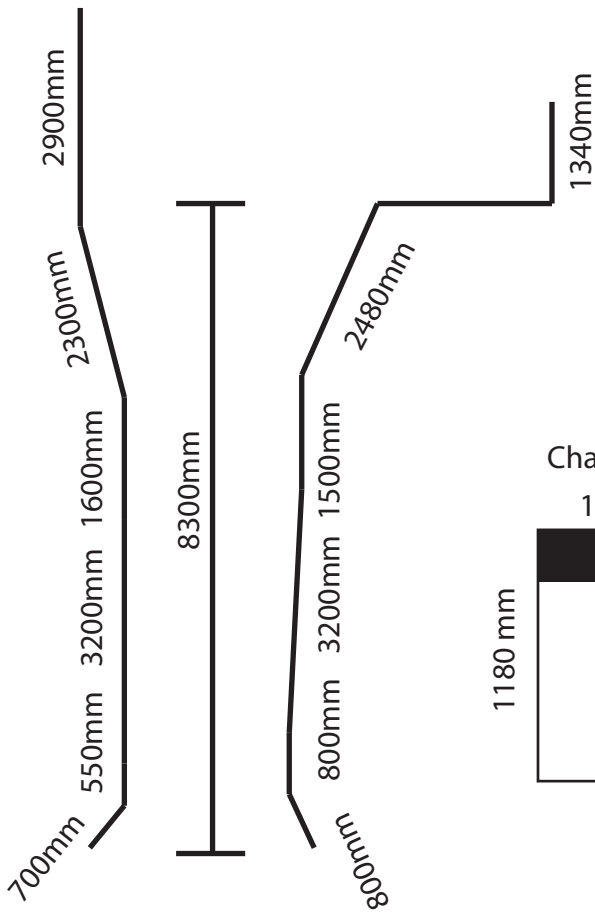

Wine Barrel Size

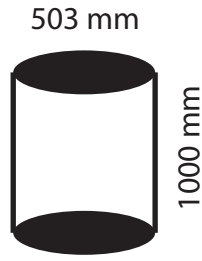

Chapel Fireplace

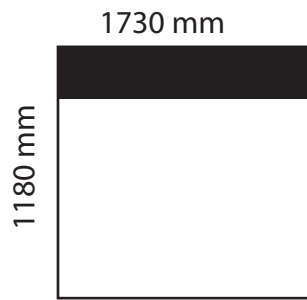

Spiral Staircase at Venue

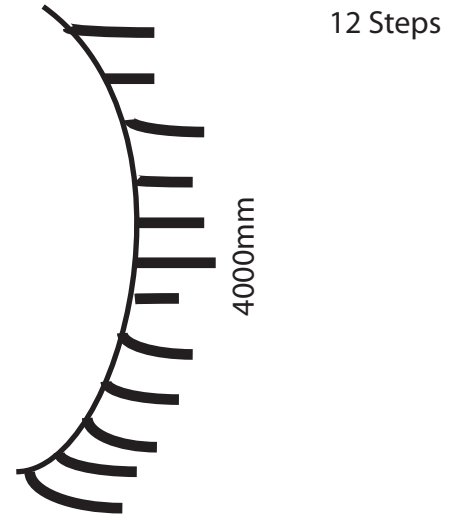

Bottom of steps leading up
Do not put anything on handrail

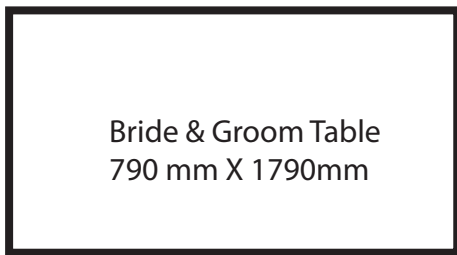

Bride & Groom Table
790 mm X 1790mm

Chapel

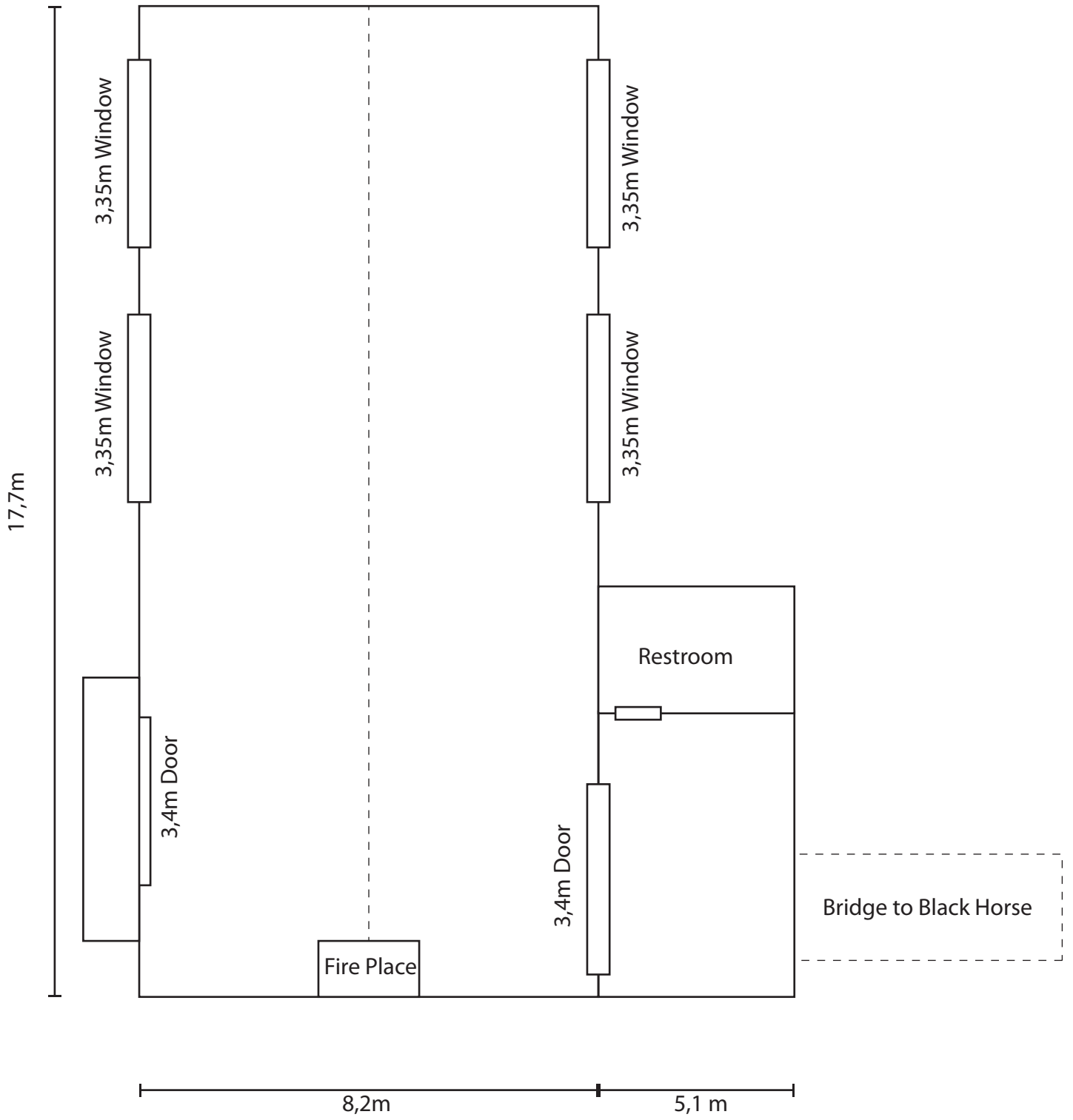

Tables

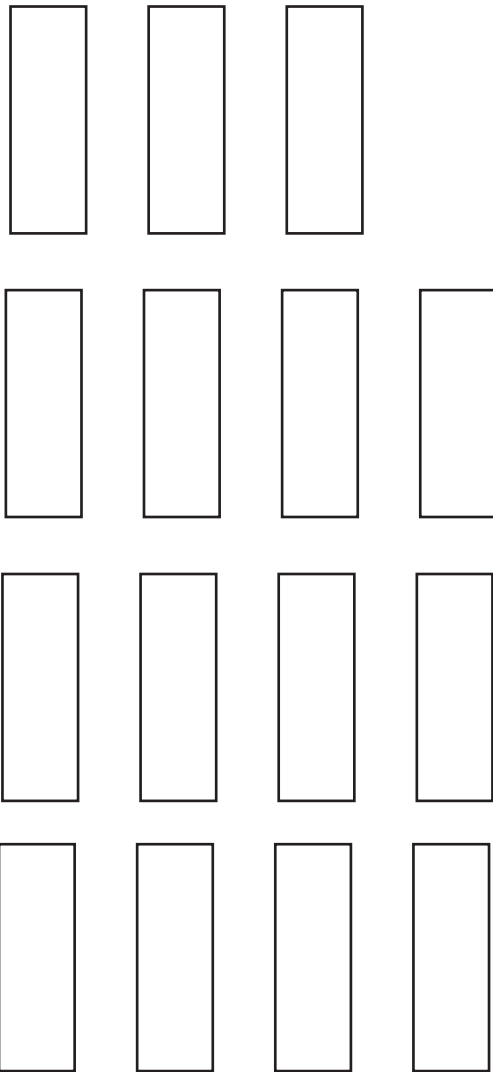

3 x 1 meter

Notes:

Tables are on scale,
cut them out and place them
on the Hall layout



Use the black boks to space
tables. it is a 2 meter spacing.

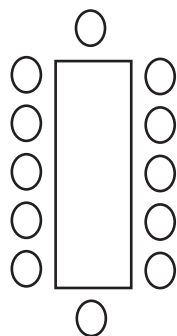

Table seating

- 12 Guests
- 10 Guests
- 8 Guests